

PIKE

VIP

# PIKE BLOCK

300 S. SALINA ST. SYRACUSE, NY



## PRIME COMMERCIAL SPACE IN HEART OF DOWNTOWN SYRACUSE

### OVERVIEW

Nestled in the heart of Downtown Syracuse, the four iconic buildings that make up Pike Block have been a hub of commerce since the early 1800's. Situated between historic Armory Square and the Central Business District, Pike Block interconnects downtown with a unique system of corridors, merging the energy of Armory Square with the visibility of South Salina Street. With strong visibility, vibrant neighbors and historic charm, Pike Block offers its tenants an ideal urban environment.

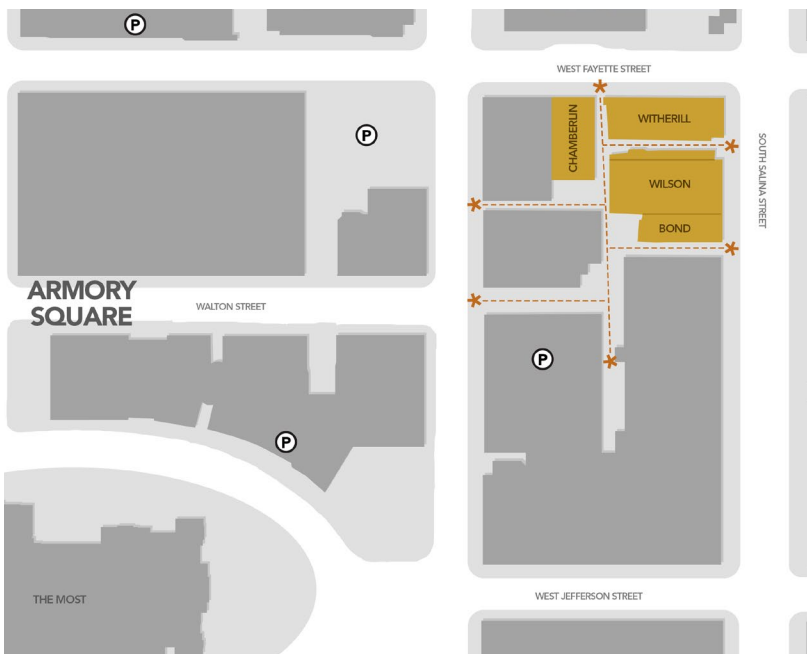

### SPACE AVAILABLE

- Professional Office Suite - 2,125 SF
- Restaurant SSpace -2,249 SF
- Unfinished: +/- 7,000 (3,000 SF and 4,000 SF suites) - plus outdoor courtyard ideal for hospitality, retail, etc.

### FEATURES | HIGHLIGHTS

- Central Downtown Location
- Multi-Street Access
- Geothermal HVAC System & LED Lighting
- Common Fitness Center
- Common Conference Room
- Common Roof Top Terrace

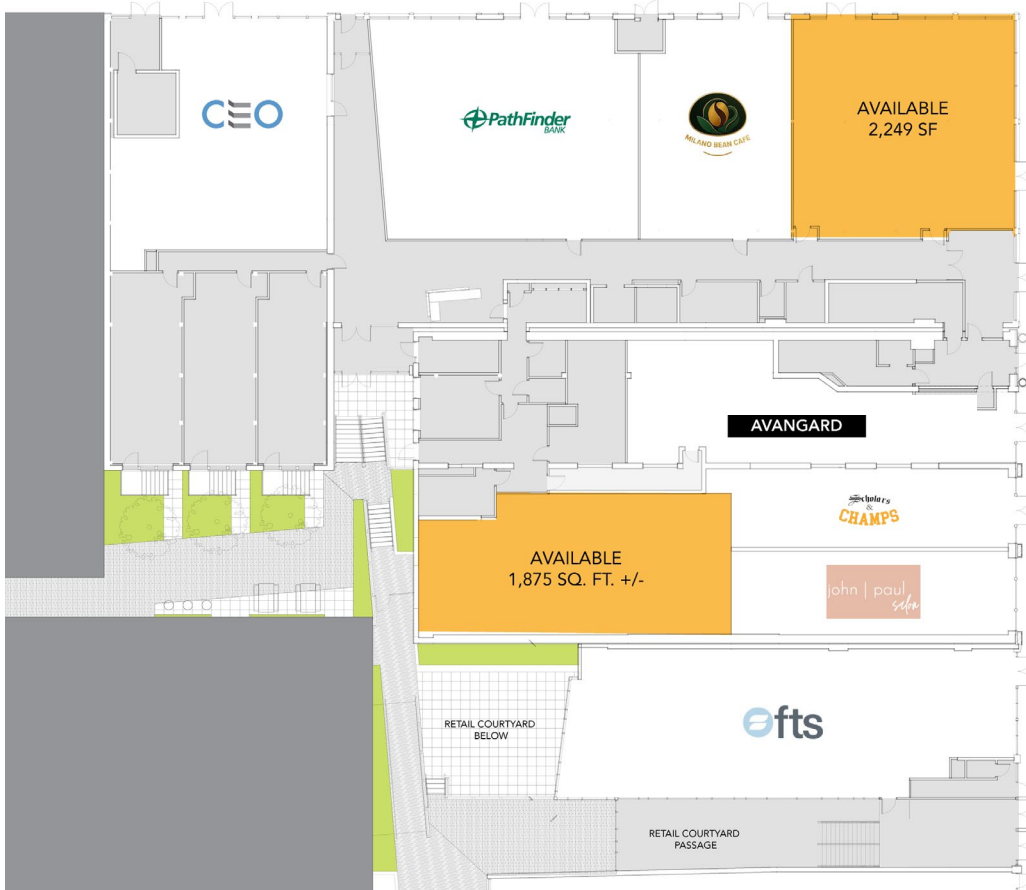

STREET LEVEL

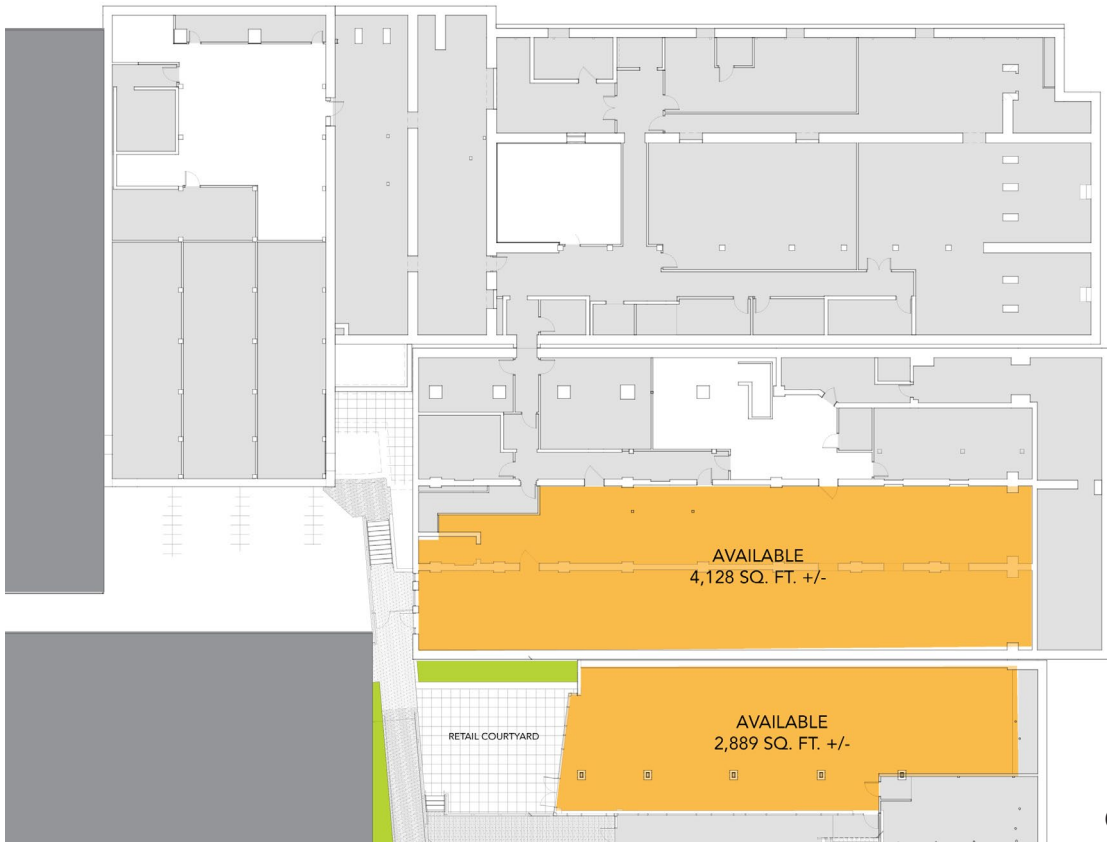

COURTYARD LEVEL